



# Pipingdesigner

## Manfred Theis

- Consulting
- Construction

### Kontakt

Tel. +49 1573 5325195  
rohrleitungsplaner@t-online.de

**AutoCAD Plant 3D · Navisworks · Revit · BIM 360**

CAD-Experience:

- AutoCad Plant 3D, 14 J.
- AutoCAD 2D, 20 J.
- Navisworks
- LiNear
- REVIT
- Solidworks
- Inventor

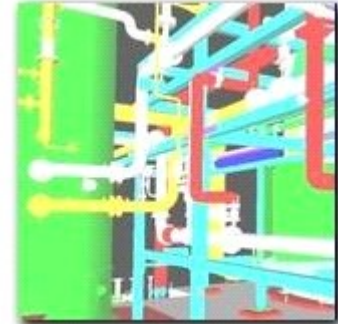
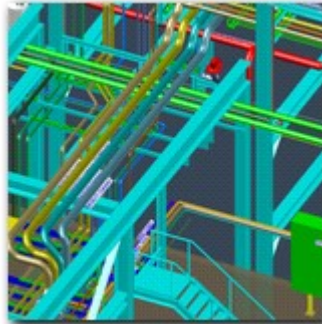

Individual contract design  
among others consulting contract.  
On-site or remote work.

Areas of activity:

- Layout planning
- R&I Schemes
- Piping Construction
- Piping supports
- Isometrics
- Layout design
- 3D-Components-Catalog
- Calculations
- Pipe Class creation
- 3D-Point-Clouds
- Production drawings
- Documentations, Bill of material
- Plastic pipe
- AsBuilts

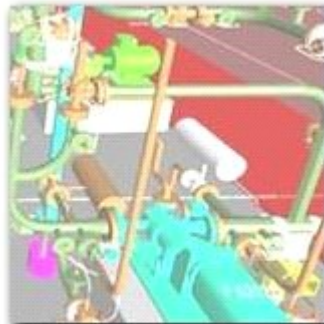

Previous constructions and  
consultations at or for:

- BASF
- ROCHE
- BAYER
- TESLA
- KHS
- LEVIAT
- FLUIDSYSTEMS
- BILFINGER
- FUCHS
- SHELL
- ROGERS
- ENVIROCHEMIE
- ABB
- MINIMAX
- u.a.

**Impressum**  
rohrleitungsplaner.de  
Manfred Theis Industrial Services  
Tel. +49 1573 5325195  
Hochstr. 17  
47228 Duisburg

A detailed project skill is  
available on request.